



SCHOOL DISTRICT 46
SUNSHINE COAST

DISTRICT FACILITIES (3.E.)

Operations Committee – June 22, 2021
Presented by Rob Collison



SCHOOL DISTRICT 46 - SUNSHINE COAST

Excellence in all we do!

Goal 3.e. – Our district facilities will be safe, engaging and energy efficient

OUTDOOR LEARNING STRUCTURE - ASSEMBLY



OUTDOOR LEARNING STRUCTURE – COMPLETED (RCES)



OUTDOOR LEARNING STRUCTURE – COMPLETED (LES)



ACCESSIBLE SWING AT LANGDALE ELEMENTARY



SOLAR INSTALLATION AT HALFMOON BAY



SOLAR AND OUTDOOR LEARNING SITE PREP - KINNIKINNICK



CEDAR GROVE ELEMENTARY SCHOOL MURALS

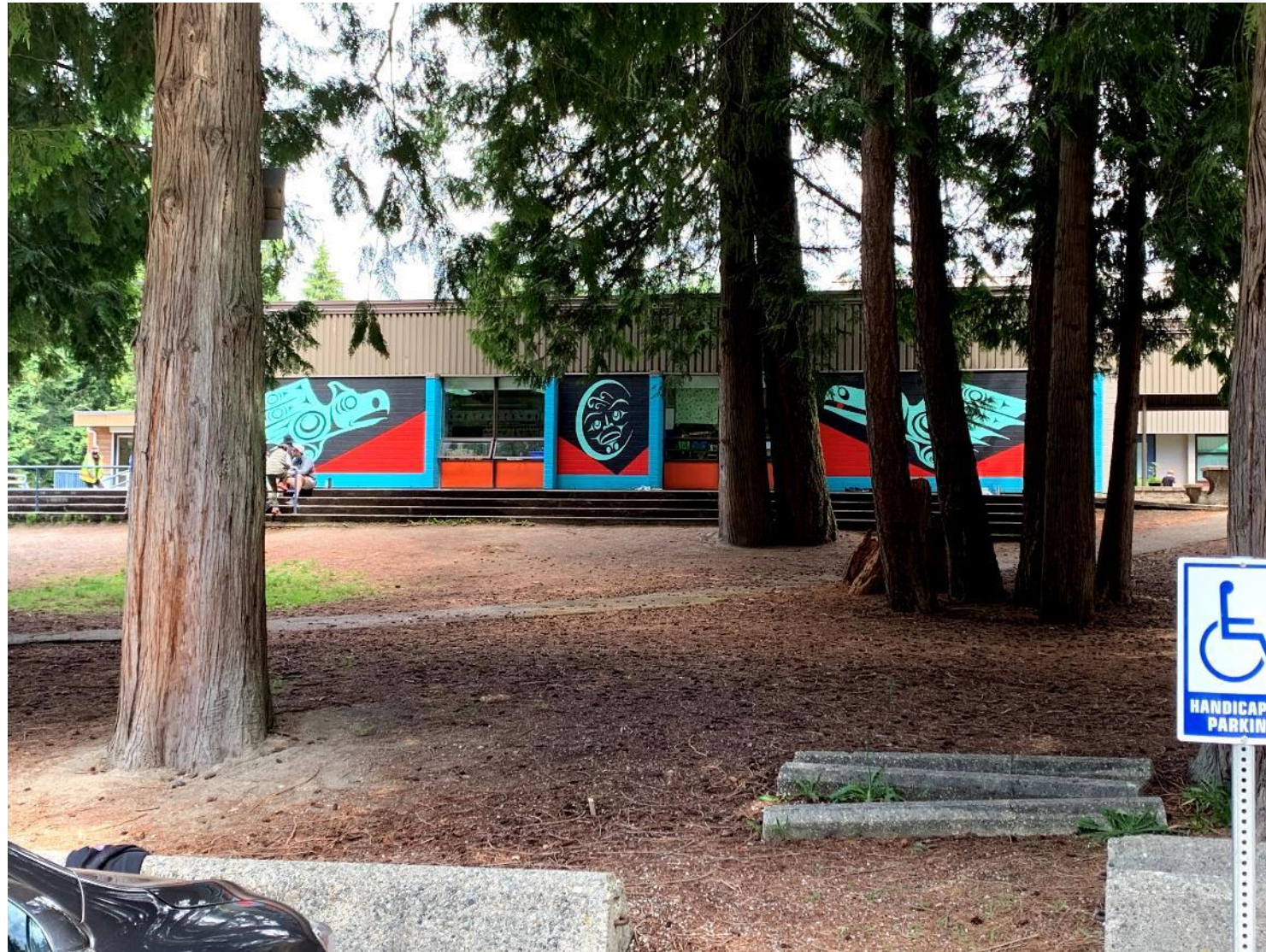

Annual Energy Savings: Meter

Project: SD #46 Sunshine Coast - PUMA (2014035)

Site: Lngdl Langdale EL

Meter: ELEC-Lngdl-01 (17830934021)

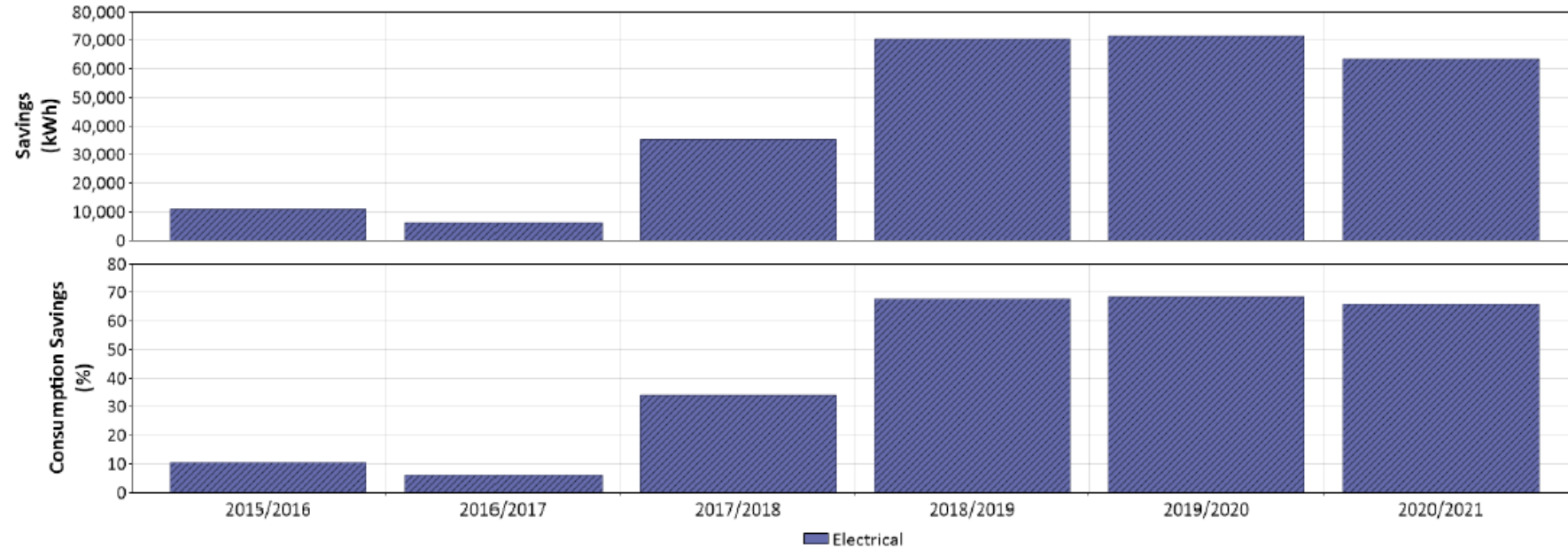

Year ¹	Electrical				
	Prorated Actual	Prorated Baseline	Savings		
			Abs. kWh	%	
2015/2016	93,463	104,426	10,963	10.5	
2016/2017	97,712	104,045	6,333	6.1	
2017/2018	68,620	104,045	35,425	34.0	
2018/2019	33,360	104,045	70,685	67.9	
2019/2020	32,800	104,426	71,626	68.6	
2020/2021	32,720	96,176	63,456	66.0	

LANGDALE ELEMENTARY - ANNUAL ENERGY SAVINGS

Annual Energy Savings: Meter

Project: SD #46 Sunshine Coast - PUMA (2014035)

Site: Gbsns Gibsons EL

Meter: ELEC-Gbsns(NEW)-01 (9385817)

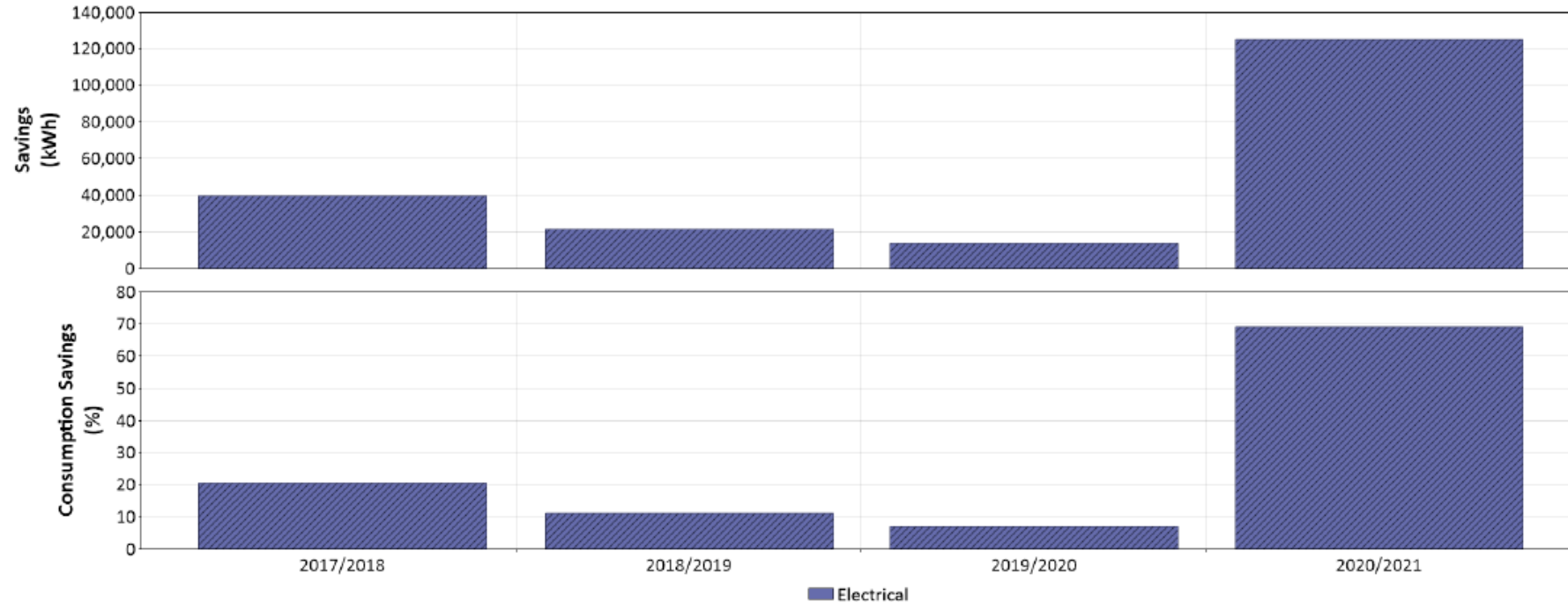

Year ¹	Electrical				
	Prorated Actual	Prorated Baseline	Savings		
	kWh	kWh	Abs. kWh	%	
2017/2018	153,280	193,123	39,843	20.6	
2018/2019	171,400	193,123	21,723	11.2	
2019/2020	179,907	193,656	13,750	7.1	
2020/2021	55,613	180,956	125,343	69.3	

GIBSONS ELEMENTARY - ANNUAL ENERGY SAVINGS

Greenhouse Gas CUSUM: Project

Project: SD #46 Sunshine Coast - PUMA (2014035)

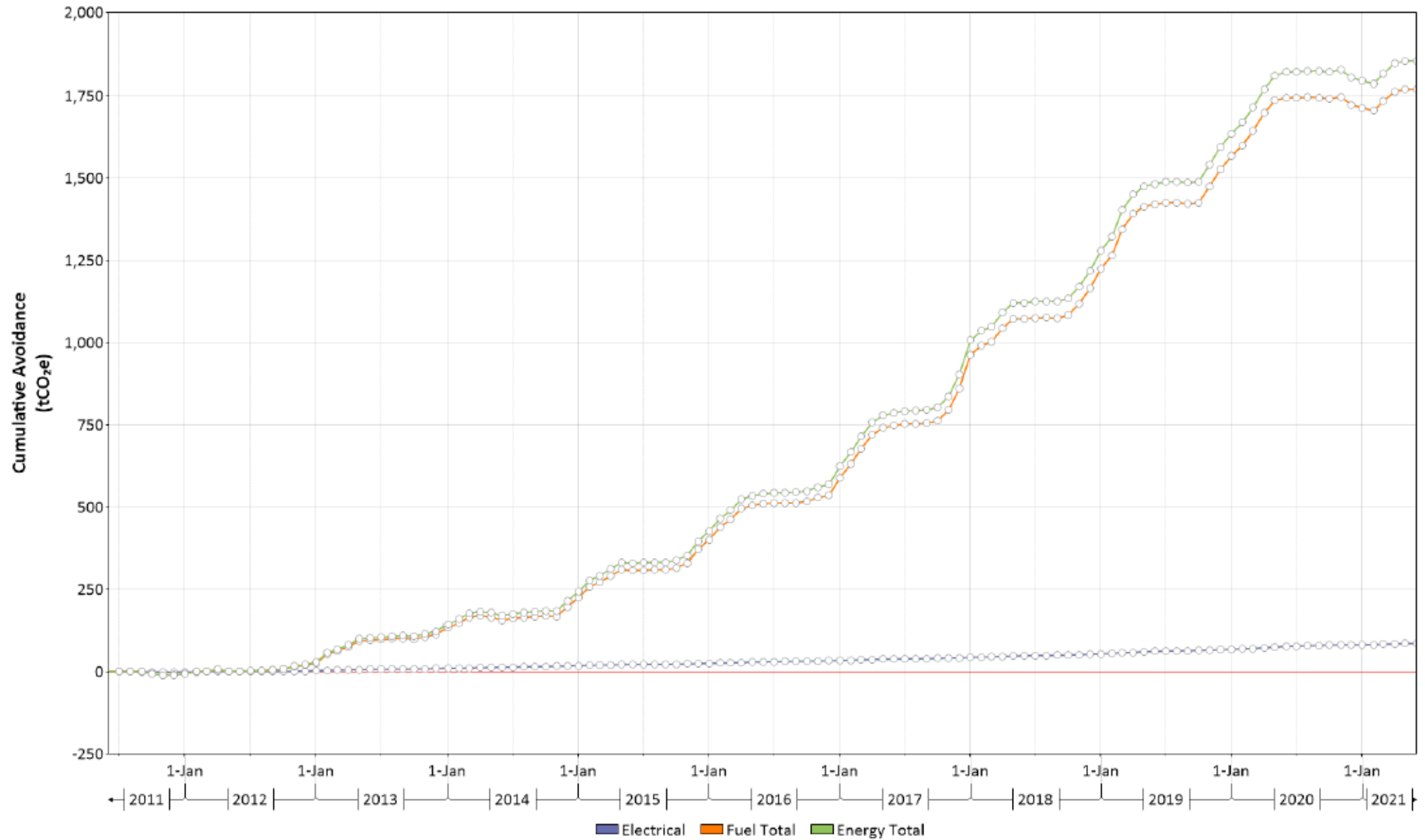

Cost CUSUM: Project

Project: SD #46 Sunshine Coast - PUMA (2014035)

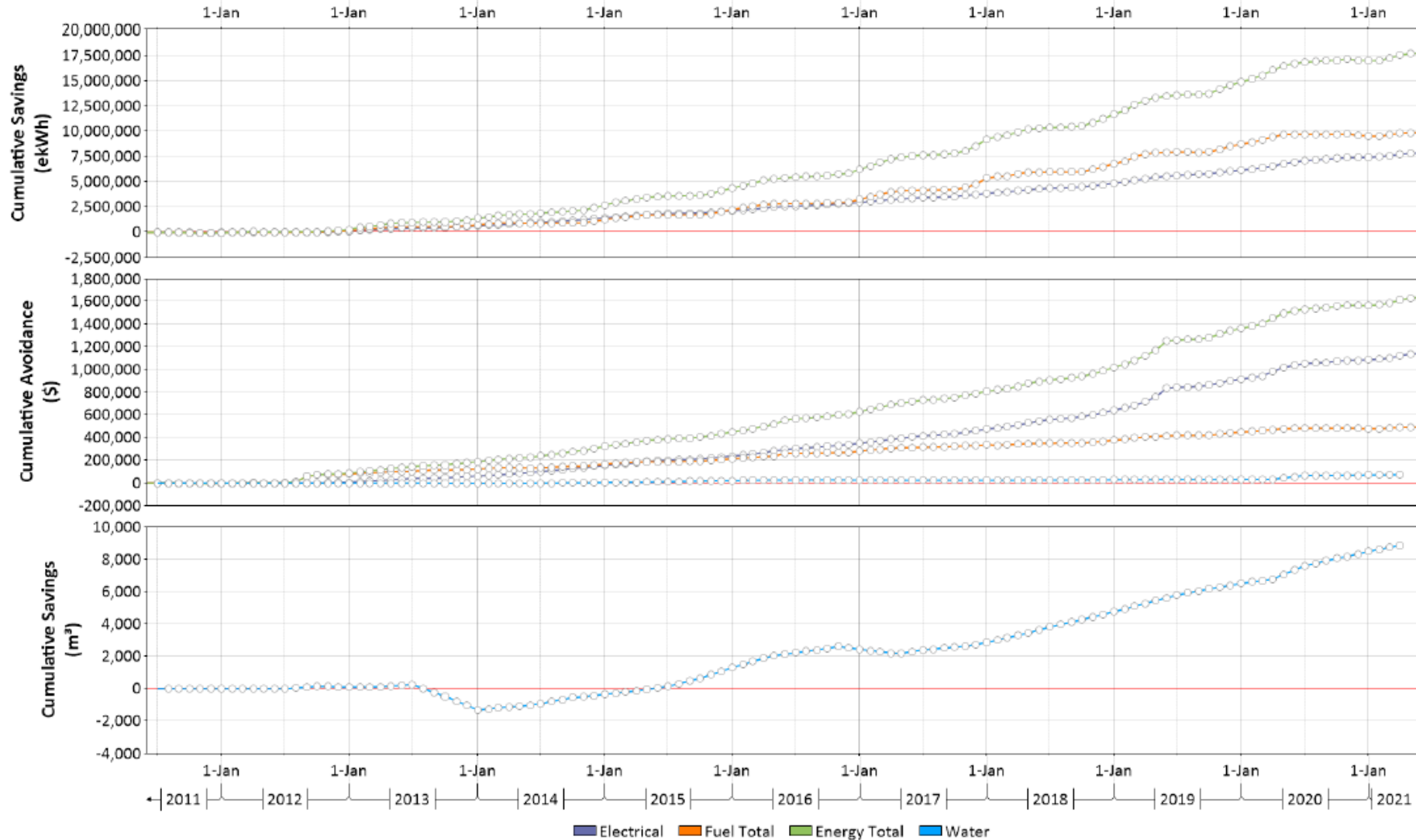

\$2,200,000 AVOIDED ENERGY COSTS SINCE 2011

WEST SECHELT EXPANSION UPDATE

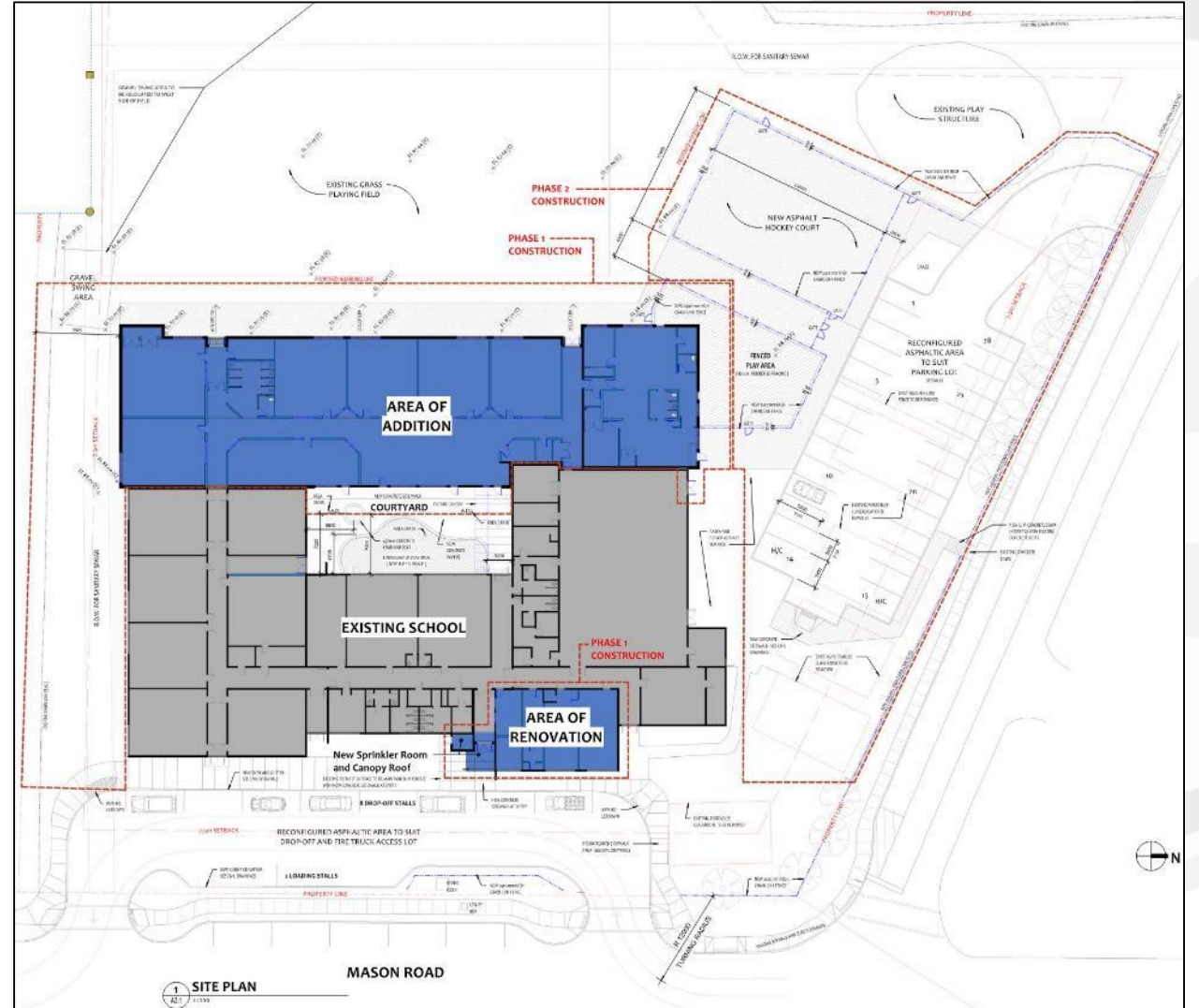



WEST SECHELT EXPANSION UPDATE





WEST SECHELT EXPANSION UPDATE





WEST SECHELT EXPANSION UPDATE





WEST SECHART EXPANSION UPDATE

- Portables to be removed starting on June 25.
- Contractor to start excavating the surface materials and adding fill material for the new access and parking lot along both Mason Road and Northwest Bay Road.
- Underground drain lines will be installed and the areas will be graded in preparation for the concrete curbs, sidewalks and asphalt.
- The placement of the asphalt will occur in mid August. There will be flag persons on the streets to control traffic during the construction activities.
- Road work, sidewalks, vehicle access and parking areas to be completed prior to the start of classes in September.